

CH

plot 2

T✓

CONTEXT F 5402

CUTTING J16 CO-ORDINATES: East 8.2 North 9.7

DATE EXPOSED 7/6/82 DATE COMPLETED

DESCRIPTION Area of soil (Dark Brown) / small stones, bounded by larger stones including some burnt - P.H.?

MAX. WIDTH AND DIRECTION 65 cm E-W

MAX. LENGTH AND DIRECTION 55 cm N-S cut by N side of J16

MAX. DEPTH/HEIGHT THICKNESS c25 cm

OVERLIES Bedrock

OVERLAIN BY ①

CUTS 5416

CUT BY

ABUTS OR CONTIGUOUS WITH

PLANS No. 1 P.T.O. Feature SECTIONS No. P.T.O.

PHOTO: B/W COL. NEG. NOS.

SAMPLE Type: Nos.

EXCAVATOR Stephanie RECORDER DBH

ASSOCIATED FEATURES 5418

ASSOCIATED FINDS pot, dark, charred, bone, nut x3, burnt bone,

COMMENT Post hole

PHASING

P.T.O.

5/19

SECTION:

S₁J16
Plan # FS402
Scale 1/10
N
↑
CH82
16/8/82
STEPHANIE



NOTES / PHOTOGRAPHS:

① PORT PIPE

Plan 2 #
S₁J16
CH82
FS402
Scale 1:10
Stephanie.

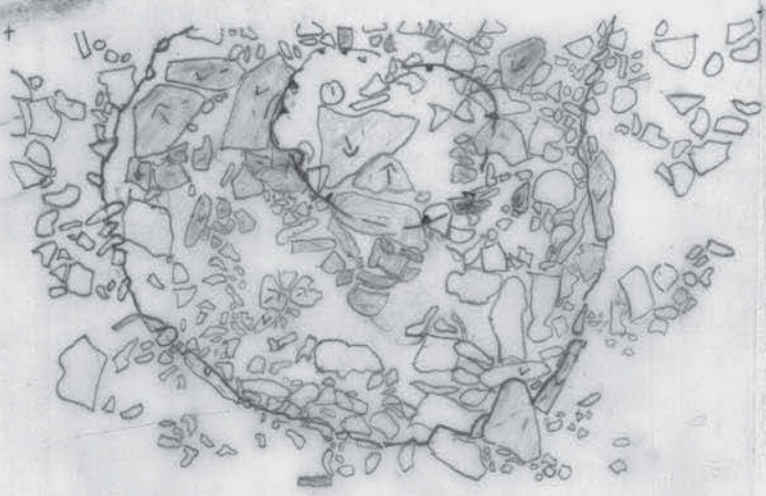

P242

CH

J16

F5402

F5402
Sq J16
25/8/82
Scale 1:10
Profile
CH82
S.M.B.

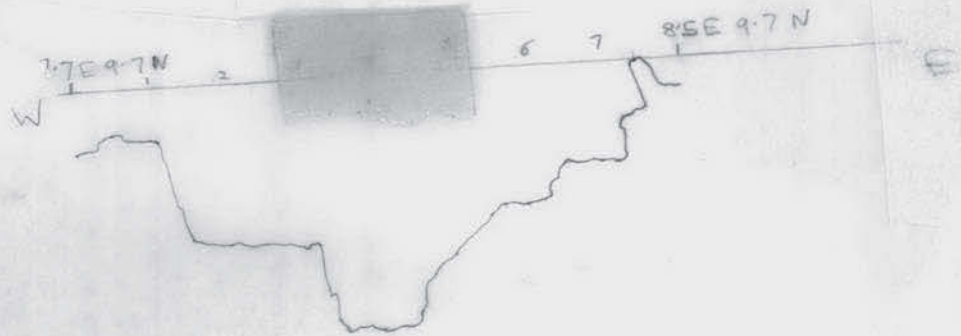

F5402 Scale 1:10 J16
suphanis

E
8.58 E.
9.96 N

