

CH 80

CONTEXT

F 3953

CUTTING *MT*

DATE EXPOSED

DATE COMPLETED

DESCRIPTION

Area on NE edge of gull-bedrock belt dipping under gull. Broken up rounded ragstone rubble. Numbered separately because of density of finds.

MAX. WIDTH AND DIRECTION

ms: 3-SE/2-SN

MAX. LENGTH AND DIRECTION

MAX. DEPTH/HEIGHT THICKNESS

OVERLIES *Bedrock; 3970*OVERLAIN BY *3920*

CUTS

CUT BY

ABUTS OR CONTIGUOUS WITH

*3931*PLANS No. *1, 4, 5*SECTIONS No. *7*

PHOTO: B/W

COL.

NEG. NOS.

SAMPLE Type:

Nos.

EXCAVATOR

RECORDER

TC

ASSOCIATED FEATURES

3950, 3970, 4011, 3957, 3931

ASSOCIATED FINDS

COMMENT

Difficult to assign this area to a period. Much of the stone is smooth - worn? If worn, why is it not completely broken up? Possibly because it was protected by soil, in which case it would not be so worn.

PHASING

All the occupation features of this area seem - superficially - to be related, in that there is a dense concentration of finds and features not matched by any ~~the~~ corresponding densities in L7 or the NE quarter of MT. A structure must have existed in this 3953/3925 area,

P.T.O.

SECTION:

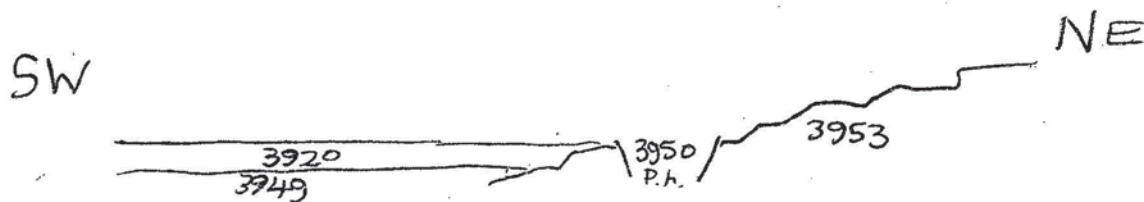

CONT'D:

although it is not clear which hearths belong to it, or to the rather unsatisfactory post holes of the area (e.g. 3952).

NOTES/PHOTOGRAPHS: