

CH 88

Not fully excavated
No samples taken

CONTEXT F 8526

CUTTING P2 CO-ORDINATES: East 8.0 North 4.0

DATE EXPOSED 26.7.88 DATE COMPLETED

DESCRIPTION Circular area of ~~flat~~ medium sized squarish stones
lying ~~and~~ more or less flat encircled at points by
definite vertical stones curving round the feature. Surrounded
by small stones of worn area 8512

MAX. WIDTH AND DIRECTION 1.00 M

MAX. LENGTH AND DIRECTION 1.00 M diameter

MAX. DEPTH/HEIGHT THICKNESS 0.42 M

OVERLIES ~~8833~~

OVERLAIN BY 8169

CUTS 8512 1 kind not ~~8833~~ bedrock 8541

CUT BY

ABUTS OR CONTIGUOUS WITH 8512?

PLANS No. 3/4 B SECTIONS No. 4L5, 4L

PHOTO: B/W COL. NEG. NOS.

SAMPLE Type: Nos.

EXCAVATOR

RECORDER Tim

ASSOCIATED FEATURES

ASSOCIATED FINDS

COMMENT

NE and SW quadrants have been
left unexcavated. No soil samples were
taken. Excavation of the two quadrants in 1988 was
perhaps too rapid to detect ^{of feature} internal features.
SE edge not at all clear.

P.T.B. Sketch plan.

7.8.88 small worn stones of 8512 around 8526 removed - thin covering
2 cms in depth - comes down to bedrock in Northwest,
and down to jumbly material in Southeast.
8512 had been kicked up against 8526 I presume.

PHASING

8-8-88 Excavated by quadrant - First NW+SE quarters removed

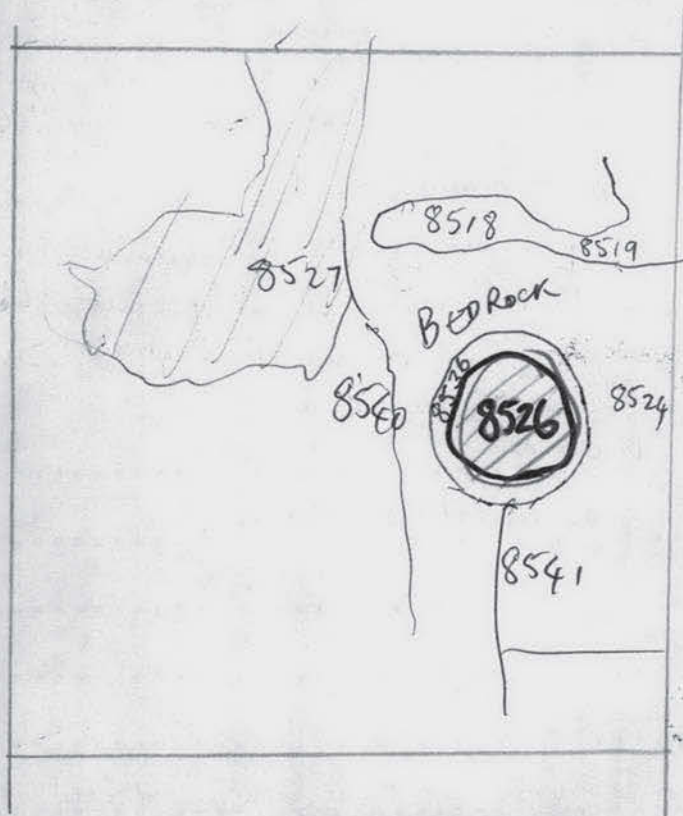

After removal of
8512

