

CH

88

CONTEXT F 8547.....

CUTTING P₂ CO-ORDINATES: East. 144 North. 7.6

DATE EXPOSED 10-8-88 DATE COMPLETED

DESCRIPTION

Possible posthole some burnt stones, too
Circular patch of small stones surrounded by
humble of 8527 and flat lying stones
(possibly 8533)

MAX. WIDTH AND DIRECTION

MAX. LENGTH AND DIRECTION 35M Diameter

MAX. DEPTH/HEIGHT THICKNESS

OVERLIES bedrock

OVERLAIN BY

CUTS 8527 (1) (2) 8561

CUT BY

ABUTS OR CONTIGUOUS WITH

PLANS No. 4 SECTIONS No. Profile

PHOTO: B/W COL. NEG. NOS.

SAMPLE Type: Nos. ,

EXCAVATOR

Christine

RECORDER

Tian

ASSOCIATED FEATURES

No soil sample taken

ASSOCIATED FINDS

COMMENT

Positive posthole - nice firm sides + bedrock base
Postpipe may have been towards east side of posthole
with it sloping up towards SE.

PHASING

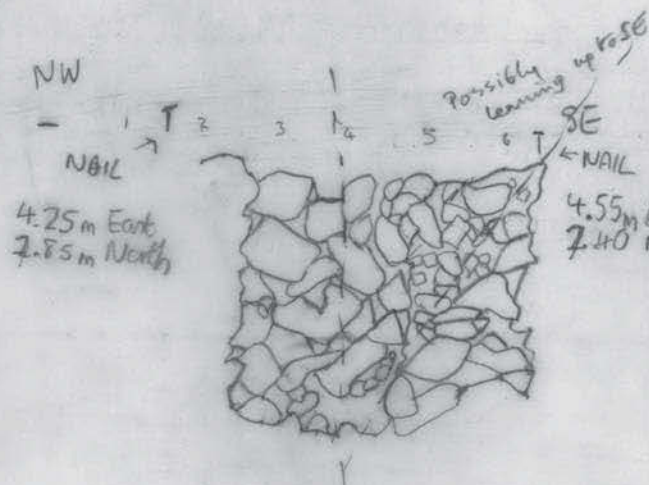
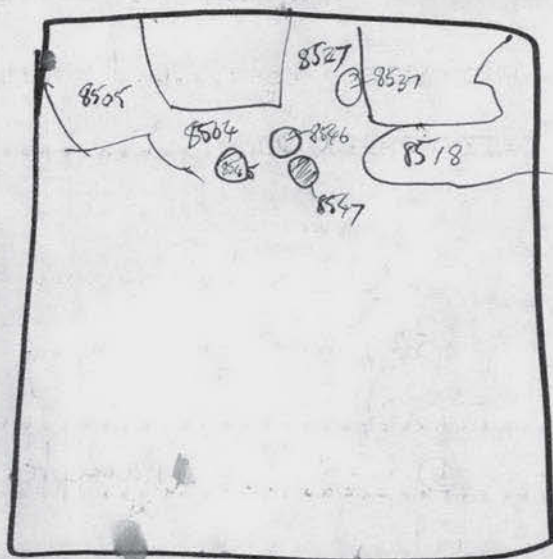

F8547

SQ P2

13/8/88

CHRISTINE