

CH 88

Not fully excavated 1988

CONTEXT F 8548

CUTTING P2 CO-ORDINATES: East 25 North 10

DATE EXPOSED 10.8.88 DATE COMPLETED

DESCRIPTION Rectangular feature outlined by vertical stones in 8521.

MAX. WIDTH AND DIRECTION 0.80m N-S

MAX. LENGTH AND DIRECTION 2.00m W-E

MAX. DEPTH/HEIGHT THICKNESS 0.30m

OVERLIES

OVERLAIN BY

CUTS 8521

CUT BY See 8558

ABUTS OR CONTIGUOUS WITH

PLANS No. 4, 4A PTO SECTIONS No. 8548 W-E N-S

PHOTO: B/W COL. NEG. NOS.

SAMPLE Type: Nos.

EXCAVATOR Paul No Soil sample taken  
Nigel RECORDER Tim

ASSOCIATED FEATURES 19.8.88 This feature has been unexcavated SW and NE quadrants, and the NW quadrant may not be down to bedrock. More careful digging in future may clarify what this pit really is.

ASSOCIATED FINDS Undetected on plan 3. But it was probably there unnoticed and only came to light with weathering.

COMMENT PTO sketch

PHASING This pit certainly seems to have had one posthole at eastern end, and possibly one or two more on western side. NW and SE quadrants were excavated, and the other two quarters were left in situ.

Burnt stone imbedded in leached grey material at 30cms depth. We are not positive we have the base on the north or south sides of the western end.

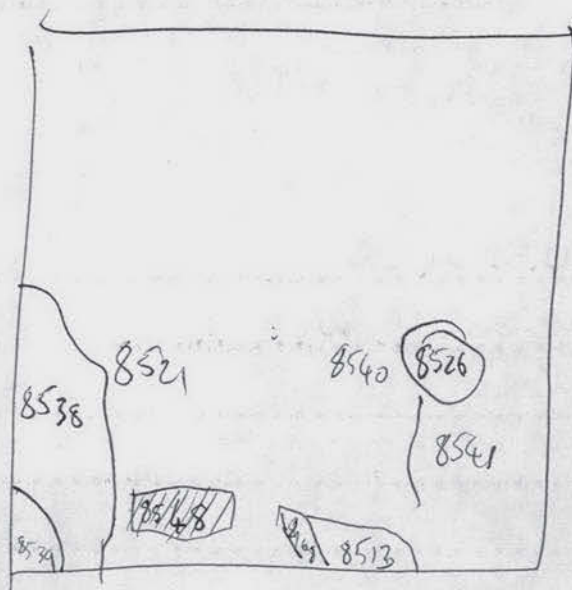

N. BRUEN 13/6/88. P2 F 8548 Plan 4D  
1:20

20N

10N

Large stones  
at all angle

15E 00N

25E 00N

35E 00N

