

CH 87

CONTEXT F 8134

CUTTING Q.2 CO-ORDINATES: East 1.5 North 9.0

DATE EXPOSED 20/7/87 DATE COMPLETED

DESCRIPTION Patch of brown humic soil Pit

MAX. WIDTH AND DIRECTION 50cms N/S

MAX. LENGTH AND DIRECTION 65cms E/W

MAX. DEPTH/HEIGHT THICKNESS 65cms

OVERLIES

OVERLAIN BY ① 8152

CUTS

CUT BY

ABUTS OR CONTIGUOUS WITH

PLANS No. Plan 1 + feature plans A & B (see over) SECTIONS No. A & B (see over)

PHOTO: B/W COL. ✓ NEG. NOS.

SAMPLE Type: Snail/Soil/Chem. Nos.

EXCAVATOR Steve Vaughn

RECORDER John G

ASSOCIATED FEATURES f 8133 - 8178

ASSOCIATED FINDS Calf's Jaw (1 1/2 - 2 1/2 years left lower mandible)
~~Pig bone~~ Pot, burnt bone (possibly Beaker domestic)
bracket piece bronze/iron

COMMENT

The burnt stone within this feature is randomly placed. Because of the increased occurrence of fragments of burnt bone all of this feature was wet sieved

PHASING

SECTION 1 of f 8133
(showing f 8133 ①)

K. Collins
1-8-87
CH 87
Q 2

Section 1.10
8133

3.8E
6.7N

3.2E
8N

okum

81330
PURE SOIL

CH 87
Q 2
1.10

3.1E
8.0N

3.8E
6.6N

PROFILE of f 8133 after the removal of the topsoil showing the dished hollow that is left in the contemporary land surface to the feature

~~FEATURES~~

SECTIONS 1 & 2 OF f8133 AND PROFILE
SHOWING CONTEMPORARY LAND SURFACE

SECTION 2 of f 8133

(showing the section of the pit fully excavated
to bedrock including f 8133(1) f 8133(2) & f 8133(3)

C.H. 87 1:10

4/8/87

4 N

Q.2

2.8E
6.6N.



CH 87 9/8/87
 O.2 (+ part of O.1)
 f.834 post excavation plan.

FEATURE PLAN (B)

Scale 1:10

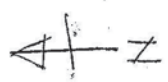
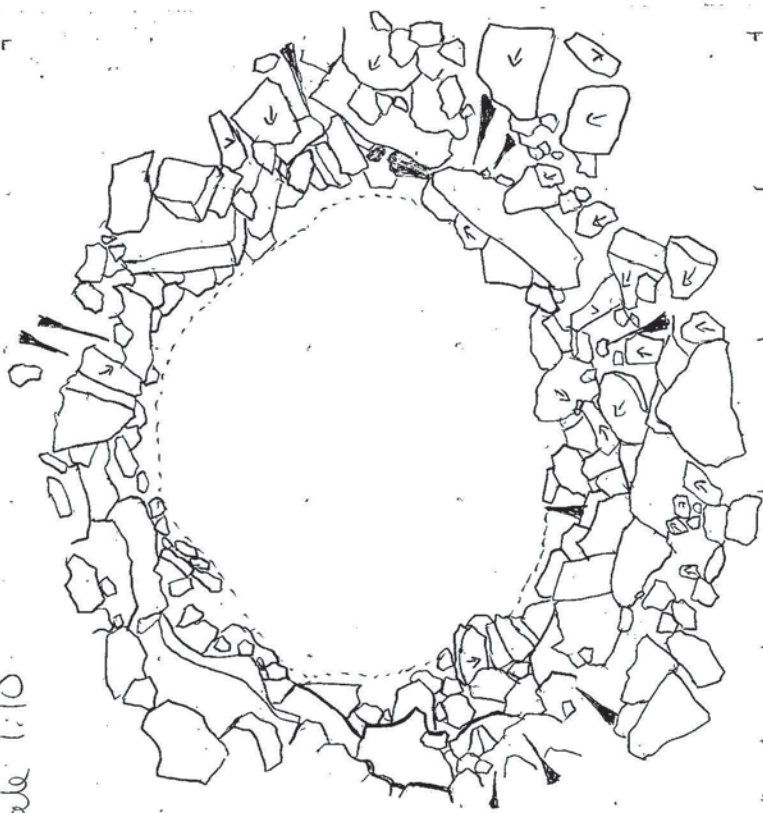

FEATURE PLAN (A)

TOP OF LAYER 2

1976 BACKFILL

CH 87 1/2/87

9N

MARGIN IN Q1 PLANNED 7/8/87

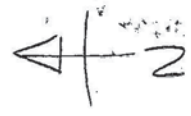

9N

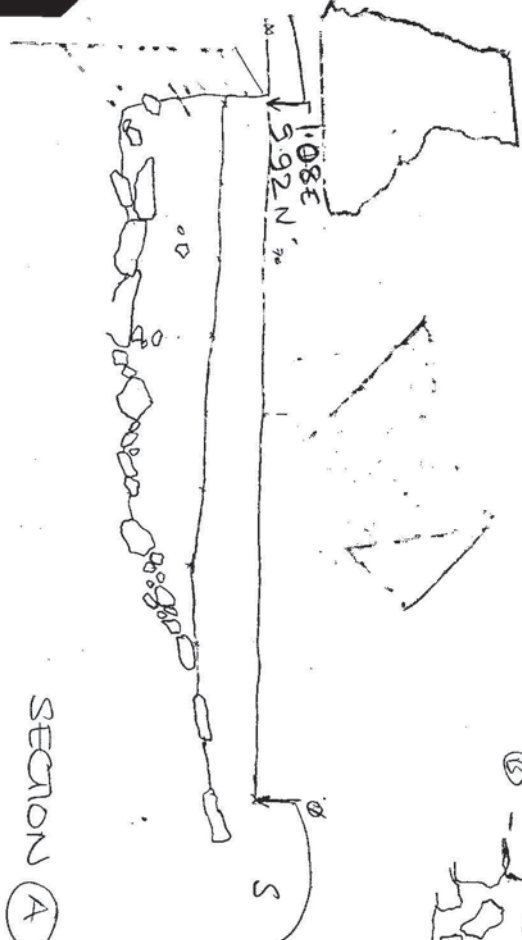

SECTION (A)



SECTION (B)



CH87
Q2
F8134
3/9/87
1:10
Section across where
facing east

- ① Dark brown soil, few small stones
- ② Large stones, many tiny, with dark grey soil infill
- ③ Light brown sticky matrix with darker stones.
- ④-⑤ Marks approx. line of small burnt gravel debris damaged & bare, not visible in section.

CH87
Q2
F8134
3/9/87
1:10
Section across
seen when
facing N.
Section line =
cutting edge