

CH

CONTEXT **F** .5796

CUTTING ..... W96 ..... CO-ORDINATES: East 6.2 North 0.4

DATE EXPOSED ..... DATE COMPLETED .....

DESCRIPTION  
Stakehole

MAX. WIDTH AND DIRECTION .....

MAX. LENGTH AND DIRECTION .....

MAX. DEPTH/HEIGHT THICKNESS .....

OVERLIES ..... F5656 (5) .....

OVERLAIN BY ..... F5656 (3) .....

CUTS .....

CUT BY .....

ABUTS OR CONTIGUOUS WITH ... LM F5750 .....

PLANS No. .... SECTIONS No. ....

PHOTO: B/W ..... COL. .... NEG. NOS. ....

SAMPLE Type: ..... Nos. ....

EXCAVATOR

RECORDER

ASSOCIATED FEATURES

ASSOCIATED FINDS  
F 5750.

COMMENT

PHASING

CH 83

CONTEXT

F 5796

CUTTING W96 ..... CO-ORDINATES East 6.2 North 8.4

DATE EXPOSED 24/8/83 ..... DATE COMPLETED 24/8/83

DESCRIPTION Stab Hole 5750,

MAX. WIDTH AND DIRECTION 4 cms. NE-SW

MAX. LENGTH AND DIRECTION 11 cms. NW-SE

MAX. DEPTH/HEIGHT THICKNESS 10 cms

OVERLIES 5656 (3)

OVERLAIN BY 5656 (3)

CUTS 5656 (4) & (5)

CUT BY

ABUTS OR CONTIGUOUS WITH

PLANS No. SECTIONS No. P.T. 9

PHOTO: B/W COL. NEG. NOS.

SAMPLE Type: Nos.

EXCAVATOR DBH

RECORDER DBH

ASSOCIATED FEATURES 5750

ASSOCIATED FINDS

COMMENT

PHASING

SECTION:

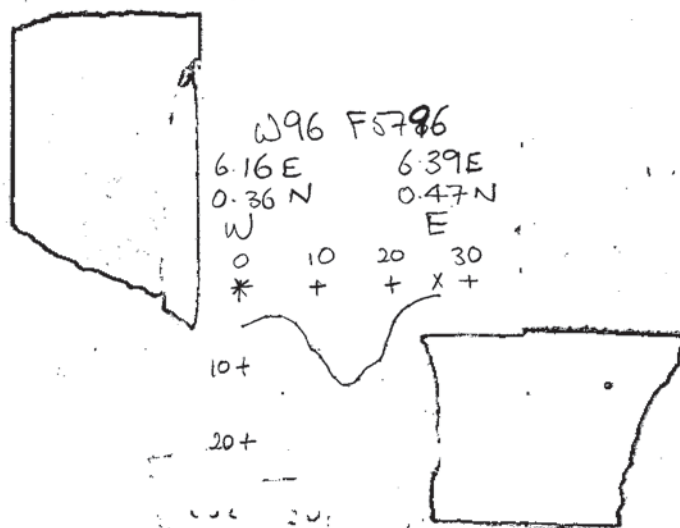

NOTES/PHOTOGRAPHS: