

CH 85

CONTEXT F 6720

CUTTING W96 CO-ORDINATES: East 1.5 North 7.6

DATE EXPOSED 26/7/85 DATE COMPLETED

DESCRIPTION Area of small burnt stones.

MAX. WIDTH AND DIRECTION 8m E-W.

MAX. LENGTH AND DIRECTION 9m N-S
MAX. DEPTH/HEIGHT THICKNESS 20cms

OVERLIES

OVERLAIN BY 6300

CUTS 6711

CUT BY

ABUTS OR CONTIGUOUS WITH

PLANS No. P.T.O. 6 SECTIONS No. P.T.O.

PHOTO: B/W COL. NEG. NOS.

SAMPLE Type: Nos.

EXCAVATOR

RECORDER DBH

ASSOCIATED FEATURES

ASSOCIATED FINDS

COMMENT

PHASING

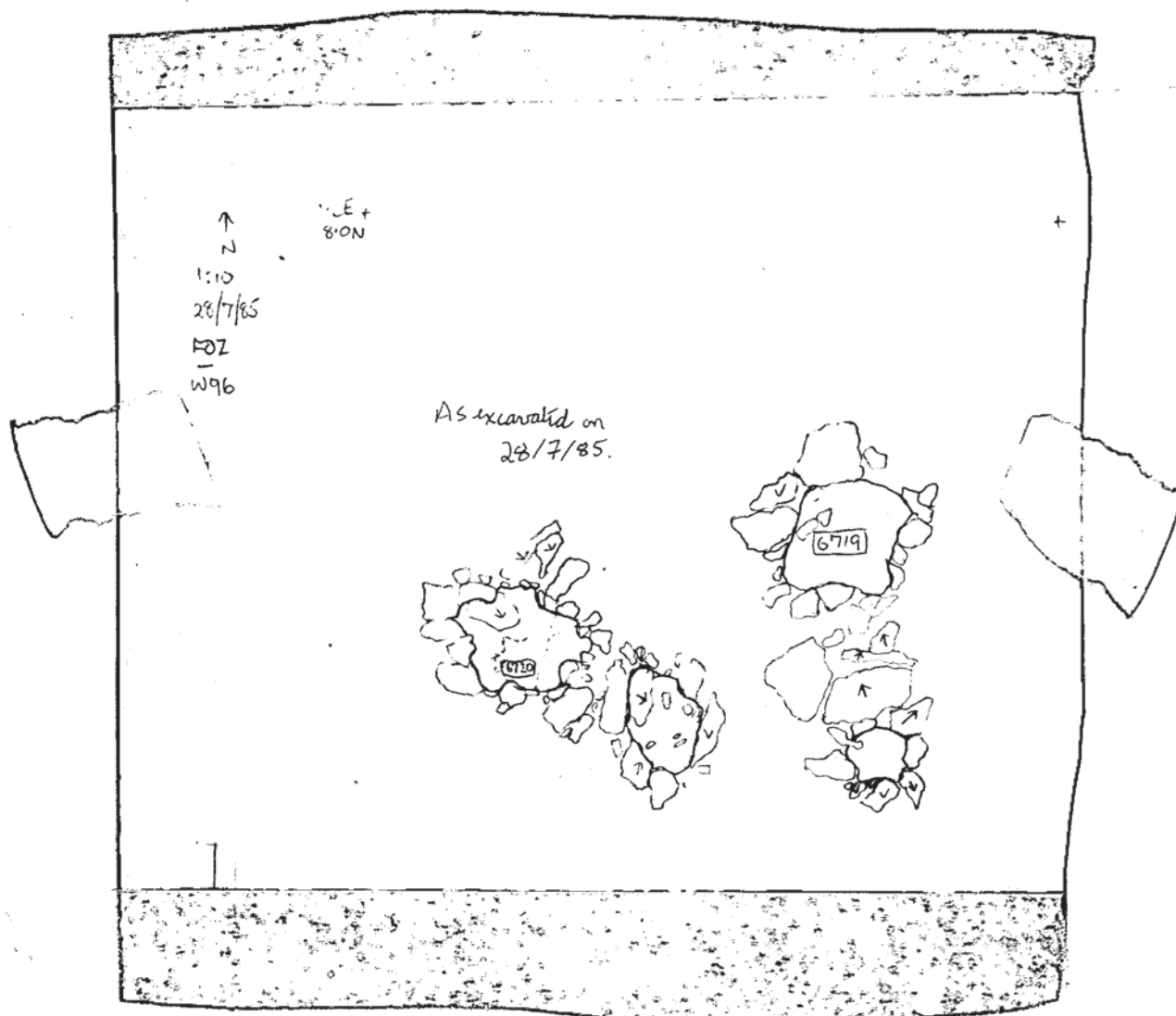
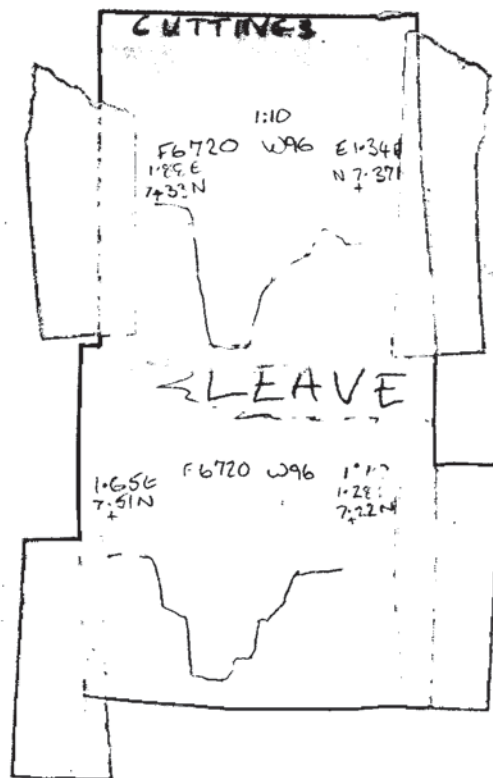

2 of 2
F6720
CUTTING W96

